

泛光灯具系列 FG03 Floodlighting luminaire series

产品特点 Material & Characteristic

- 高压压铸铝成型外壳，外部静电喷涂处理。
- 进口高纯铝制反射器，对称型配光。
- 内置遮光板，使投光光束集中，提高光线利用率，并有效防止眩光和光污染。
- 耐高温硅橡胶密封带和钢化玻璃。
- 灯具内侧附有刻度板，方便调整照射角度。
- 背后开启式更换灯泡，方便维护。
- High-pressure die-casting aluminum shell, external static spraying processing.
- Imported high-purity aluminum reflector, symmetric light distribution.
- Built-in plate to concentrate the light beam which improves the light efficiency and effectively prevent glare and light pollution.
- High temperature resistant silicon rubber sealing and tempered glass.
- Calibration plate inside the luminaire to facilitate angle adjustment.
- Back cover open design for light source replacement and easy maintenance.



建议配套我司电器箱-K箱
It is recommended to use
Huaquan gear box model no.
HQBNXXL-K

应用范围 Applications

- 建筑物、体育场、广场、码头、绿化照明、广告、大厦外景、车站、铁路、隧道、港口等户外照明。
- Buildings, stadiums, squares, docks, green lighting, advertising, building outlines, stations, railways, tunnels, ports and other outdoor lighting.

配光曲线 Luminous intensity curve

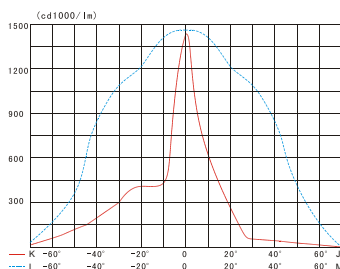
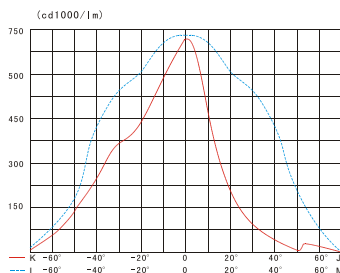

技术参数 Product Parameter

IP
65

型号 Model	光源/灯功率 lamp	灯头 Base	电压/频率 Voltage & frequency
HQBN-1000L/FG03	HPS 1000W	E40/X528	220V/50Hz
HQBG-1000L/FG03	MH 1000W	E40/X528	220V/50Hz
HQBN-2000L/FG03	MH 2000W	X528	220V/50Hz

产品特点 Material & Characteristic

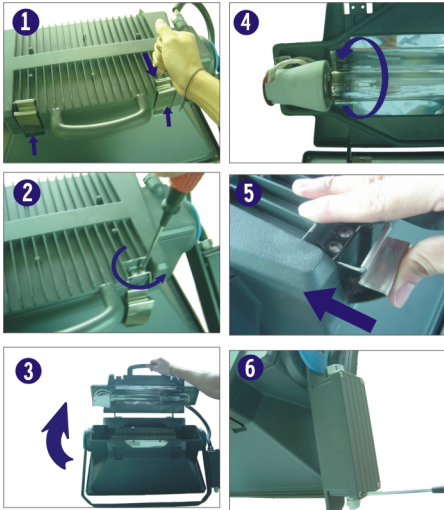

光源安装步骤:

步骤一：用小号一字螺丝刀打开灯具背后两个压扣，如图1所示。
 步骤二：用十字螺丝刀松开两个压扣下的紧锁螺丝以打开灯具的后盖。
 步骤三：松开灯具压扣后如图3所示向上打开灯具后盖。
 步骤四：按图4所示把光源装入灯座内，注意：安装光源时请先戴上布质手套以保护光源。
 步骤五：安装好光源后，把后盖合上并上好紧锁螺丝，如图5所示用力把压扣扣紧后盖。
 步骤六：用十字螺丝刀如图6所示将密封盒打开，将外部电缆穿过防水接头，并将线接好。

Lamp installation steps:

Step One: Use small screwdriver to open the two buttons on back cover, as shown in Figure 1.
 Step Two: Cross screwdriver to loose the locking screw under two pressing buttons under to open the rear lamp cover.
 Step three: Loose two pressing buttons to open up the rear lamp cover as shown in Figure 3.
 Step four: As shown in Figure 4, screw the light source into the lamp holder. Note: Please wear the cloth gloves to protect the lamp.
 Step Five: Close the rear cover and tight the locking screw after light source is installed. Press the pressing button and lock the rear cover as shown in Figure 5.
 Step Six: Use cross screwdriver shown in Figure 6 to open the sealed box. Put the outside cable through the water-proof connectors, and connect it well.

灯具尺寸及安装方式: Luminaire installation:

